

# Technical data sheet

## Product features



### Pot and pan washer double skin with drain pump 55x61 - 400 V

<b>Model</b>	<b>SAP Code</b>	00011967
--------------	-----------------	----------



- Display type: LCD multifunction display
- Number of programs: 11
- Number of skin: 2
- Door clear height [mm]: 650
- Rack size [mm]: 560 x 630
- Water consumption of the washing cycle [l/basket]: 3
- Detergent and rinse pump system: ProDose - accurate dosing with a peristaltic pump
- Wash pump type: two-way - DuoFlow
- Self-cleaning cycle: Yes
- Drain filter: Evolution3 - double filtration with electronically controlled partial discharge before the rinsing phase ensures 0% loss of clean water to waste

<b>SAP Code</b>	00011967	<b>Power electric [kW]</b>	10.500
<b>Net Width [mm]</b>	782	<b>Loading</b>	400 V / 3N - 50 Hz
<b>Net Depth [mm]</b>	719	<b>Water consumption of the washing cycle [l/basket]</b>	3
<b>Net Height [mm]</b>	1727	<b>Door clear height [mm]</b>	650
<b>Net Weight [kg]</b>	148.00	<b>Rack size [mm]</b>	560 x 630

# Technical data sheet

Technical drawing



Pot and pan washer double skin with drain pump 55x61 - 400 V

Model

SAP Code

00011967

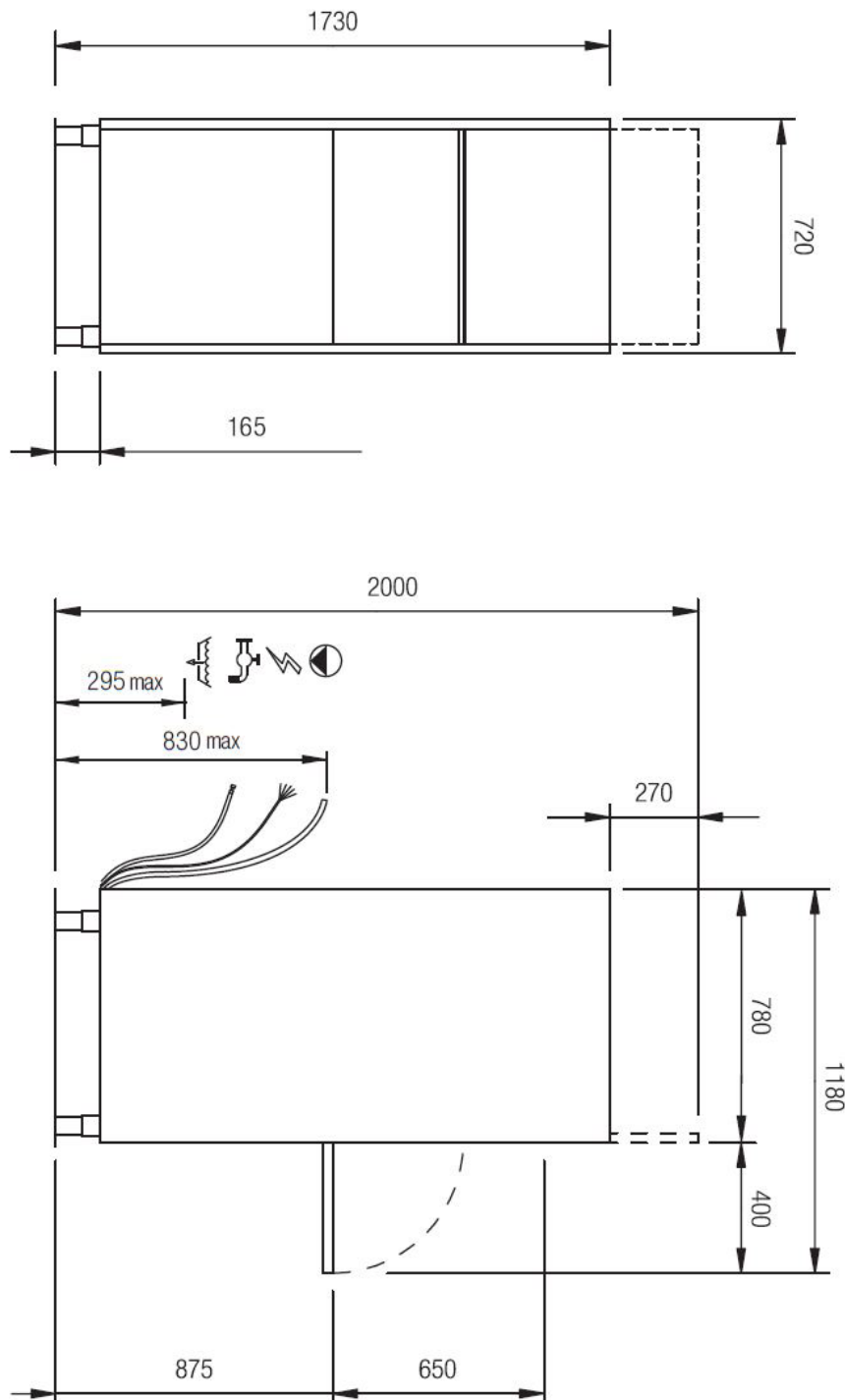

# Technical data sheet

## Product benefits



### Pot and pan washer double skin with drain pump 55x61 - 400 V

Model	SAP Code	00011967
-------	----------	----------

**1** **Stainless steel outer shell construction**  
round construction with stainless steel, rounded edges, Deep-drawn bathtub  
– easy cleaning, high hygiene standard, long service life

**2** **Stainless steel washing arms**  
upper and lower arms with stainless steel, separated for washing and rinsing, triple upper arm  
– easy and safe handling during cleaning; higher user comfort

**3** **LED Display**  
smartScreen, a large color graphic display showing the washing progress  
– easy control of the dishwasher operation  
– continuous information on the status of the wash cycle  
– diagnostics in the event of a fault

**4** **Double pump**  
unique two-way DuoFlow pump  
– distributes the water pressure evenly between the upper and lower arms; no noise; allows the use of a weaker pump

**5** **Detergent dispensers**  
two detergent and rinse aid dispensers  
– precise chemical dosing by ProDose - precise dosing system for detergent and rinse aid by peristaltic pump setting of values via control panel

**6** **Double filter system**  
the chamber filter and the waste filter together with the ArchiMedes system provide a discharge system with increased water purification efficiency  
– higher washing efficiency; longer life of the washing bath

**7** **Energy saving**  
energy saving energy saving system due to lowering the temperature of the boiler  
– cost saving

**8** **Protection of fragile dishes**  
softstart system for gradual start of washing programs to protect fragile dishes  
– protects stemmed glasses and other fragile utensils

**9** **Double shell construction**  
stainless steel construction with insulated double jacket  
– quiet operation  
– energy saving

**10** **Fast heating**  
performance management allows the current running of the boiler and basins body  
– quick first warm-up of the dishwasher  
– smooth operation

**11** **Air break tank**  
the open system of the boiler rinse, in cooperation with the rinse pump, ensures a constant pressure and temperature of the rinse  
– possibility to use in HACCP systems water temperature suitable for sterilization

# Technical data sheet

Technical parameters



## Pot and pan washer double skin with drain pump 55x61 - 400 V

Model	SAP Code	00011967
-------	----------	----------

**1. SAP Code:**

00011967

**15. Number of programs:**

11

**2. Net Width [mm]:**

782

**16. Opening of device:**

Tilting down

**3. Net Depth [mm]:**

719

**17. Door clear height [mm]:**

650

**4. Net Height [mm]:**

1727

**18. Inlet pressure [bar]:**

2-4

**5. Net Weight [kg]:**

148.00

**19. Adjustable feet:**

Yes

**6. Gross Width [mm]:**

870

**20. Number of skin:**

2

**7. Gross depth [mm]:**

890

**21. Self-cleaning cycle:**

Yes

**8. Gross Height [mm]:**

2200

**22. Number of arms for both rinsing and washing:**

2

**9. Gross Weight [kg]:**

157.00

**23. Arm connection:**

Click-clack - easy removal with one hand

**10. Device type:**

Electric unit

**24. Washing arm type:**

Rotating trident

**11. Control type:**

Digital

**25. Washing arm material:**

Composite

**12. Material:**

AISI 304

**26. Atmospheric boiler with rinse pump:**

Yes

**13. Power electric [kW]:**

10.500

**27. Rinsing arm type:**

Rotating trident

**14. Loading:**

400 V / 3N - 50 Hz

**28. Rinsing arm material:**

Composite

# Technical data sheet

## Technical parameters



### Pot and pan washer double skin with drain pump 55x61 - 400 V

<b>Model</b>	<b>SAP Code</b>	00011967
--------------	-----------------	----------

**29. Deep drawn tank:**

Yes

**30. Rack support:**

Pressed

**31. Tank surface strainers:**

stainless steel

**32. Drain filter:**

Evolution3 - double filtration with electronically controlled partial discharge before the rinsing phase ensures 0% loss of clean water to waste

**33. Thermostop:**

Yes

**34. Boiler thermostat adjust:**

Yes

**35. Detergent and rinse pump system:**

ProDose - accurate dosing with a peristaltic pump

**36. Energy Saving system:**

EnergySaving - Energy saving system due to lowering the boiler temperature

**37. Rinse system:**

ProRinse - composite arms common for rinsing and washing with geometry for spraying water in thin jets directly against the dishes, the rinsing pump ensures constant pressure

**38. Heating system:**

HotWash - System of simultaneous operation of the heating element of the bath and the boiler, reducing the time for starting the next cycle

**39. Quick heating system:**

QuickReady - System for rapid heating of water in the tank

**40. Hot water electric valve:**

Yes

**41. Closing door system:**

ProSoft - Reduces noise, dampens the door stop, which could cause damage to dishes

**42. Rack size [mm]:**

560 x 630

**43. Display type:**

LCD multifunction display

**44. USB port:**

Yes, for Firmware actualisation

**45. Drain pump:**

Yes

**46. Self-diagnostics:**

Yes

**47. Wash pump type:**

two-way - DuoFlow

**48. Detergent dispenser:**

Yes

**49. Rinse aid dispenser:**

Yes

**50. Water consumption of the washing cycle [l/basket]:**

3

# Technical data sheet

Technical parameters



## Pot and pan washer double skin with drain pump 55x61 - 400 V

Model

SAP Code

00011967

### 51. Rinse water temperature [°C]:

80-85

### 52. Additional information:

The product comes with 1x RM Clean+ 12 kg (00012271) and 1x RM Rinse+ 10 kg (00012273) for free

### 53. Program ProFessional 2:

Yes

### 54. Program ProFessional 4:

Yes

### 55. Program ProFessional 6:

Yes

### 56. Program ProFessional 8:

Yes

### 57. Program ProFessional 10:

Yes

### 58. Program ProClean:

Yes

### 59. Program ProDrain:

Yes

### 60. Program ProEco:

Yes

### 61. Program ProLong:

Yes

### 62. Program ProActive 5:

Yes

### 63. Program ProActive 7:

Yes